

Celebration Precinct

Pierside Precinct

Water Recreation Precinct



- Site area
 - Existing footbridges
 - Existing landmarks
 - Posposed landmarks
 - Posposed footbridges and underground linkages
- 0m 80m 160m

Transforming a harbourside, or waterfront into a dynamic destination could unlock great potential of an area or even the whole city by boosting the economy as well as triggering positive social effect. The WANDerland project in Wan Chai North aims to encourage public participation in the currently under-utilized waterfront by promoting mixed use, diversity and sustainability. WANDerland, from its literal meaning, suggests that the space is an urban dreamscape like a wonderland that encourages people to 'wander' and explore.

The whole stretch is divided into three zones, each with a unique theme to cater the need of different users and promote interaction with water. By reconnecting people to local culture of and reminding the history of Wan Chai, the project could help building up a strong community identity and establish a sense of pride.

WANDerland

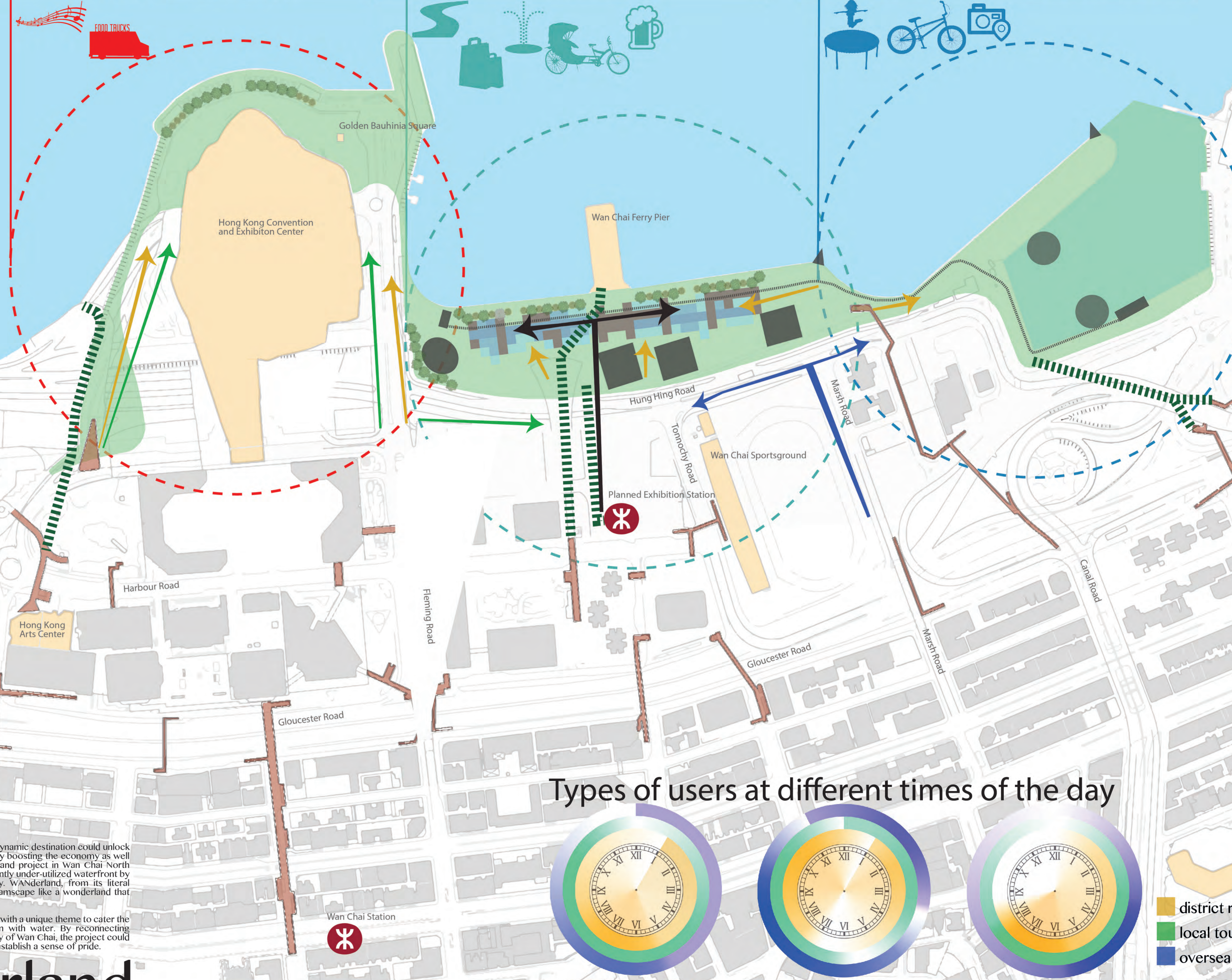

Types of users at different times of the day



- district residents
- local tourists
- overseas tourists

Celebration Precinct

The Celebration Precinct is designed for use all year round, not limited to a few large scale commemorative events in the year. People would enjoy themselves there and feel the sense of joy and celebration.



Golden Bauhinia Square During Celebration



Golden Bauhinia Square in Normal Days



Electric Guzhang

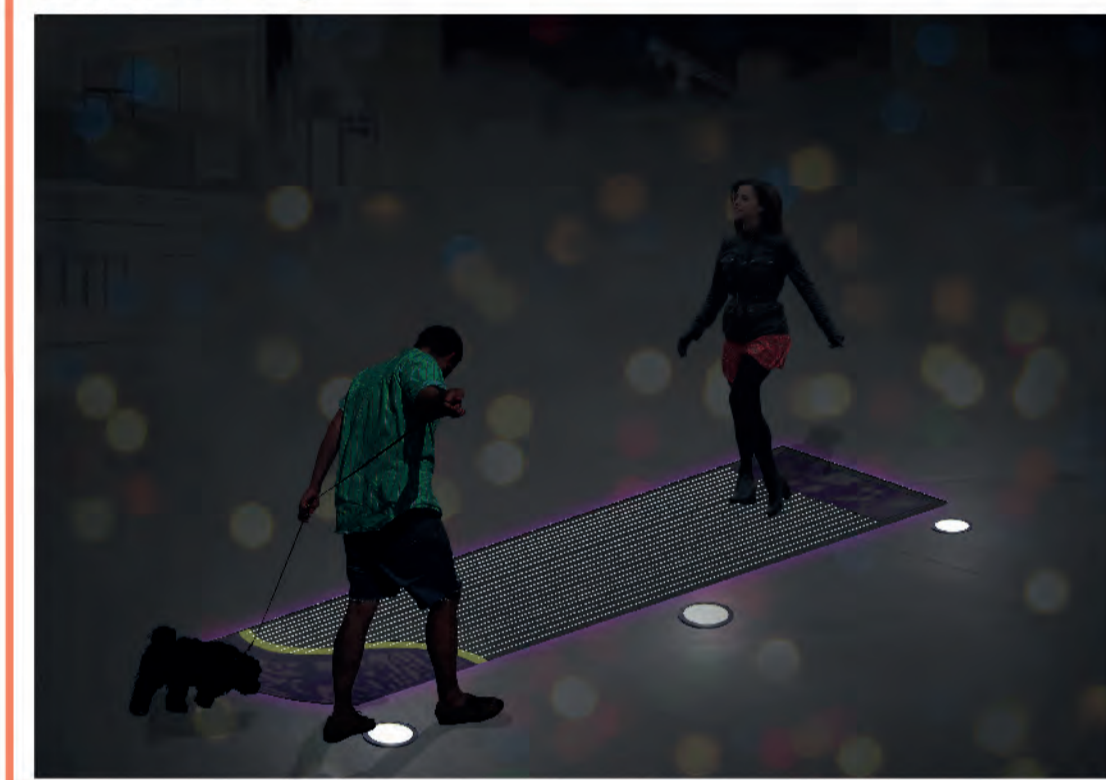

- 1 ElectGolden Bauhinia Square
- 2 Leisure Grassland
- 3 Food truck & Carnival zone
- 4 Golden Bauhinia Square
- 5 The Hong Kong Convention and Exhibition Center

Pierside Precinct

It is characterised by its incorporation of water features and commercial elements. Seating areas and observation decks would also be provided to cater the needs of different users.

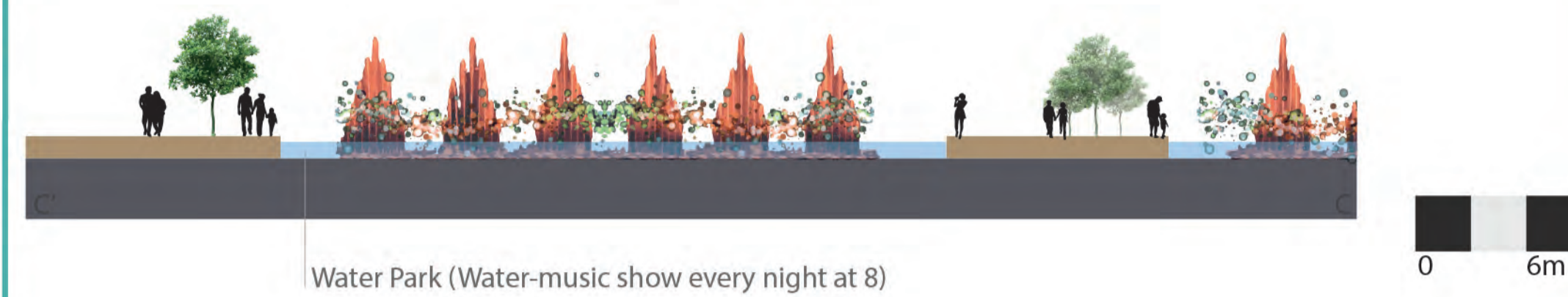

Water Park (Water-music show every night at 8)

Markets



Waterside Bar



Harbour Deck

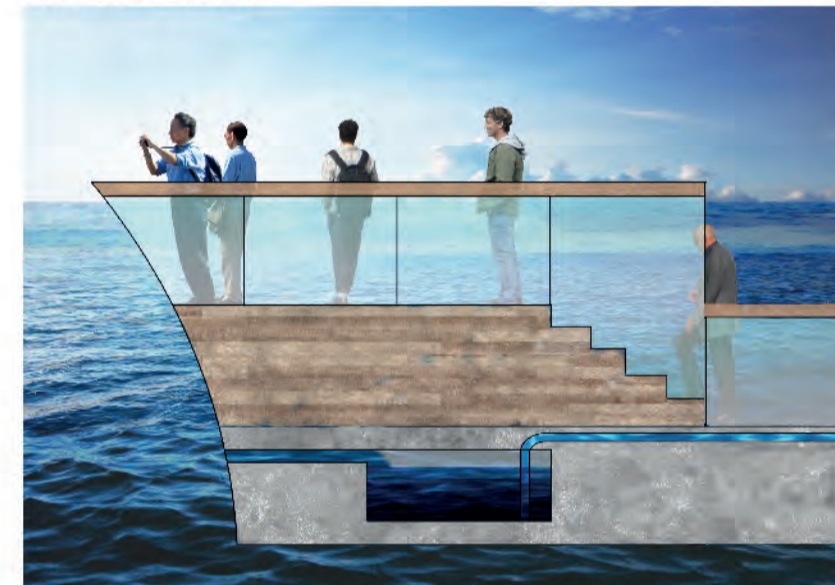

Public Square



Waterfront Terrace

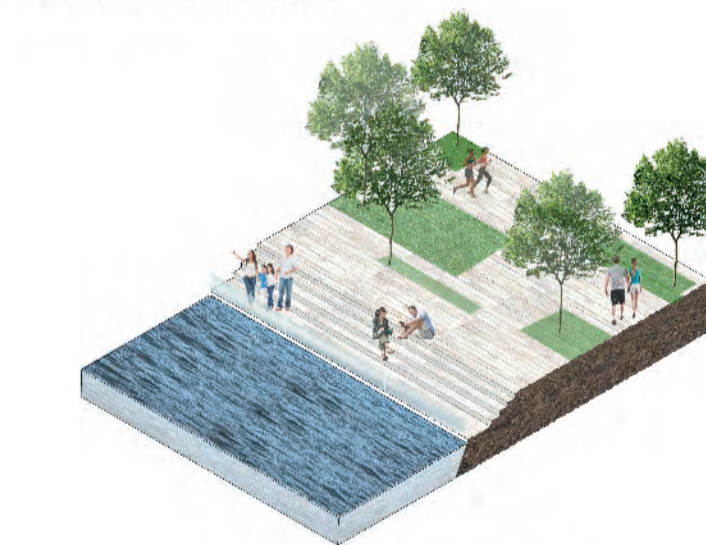

Rickshaw Station (East)

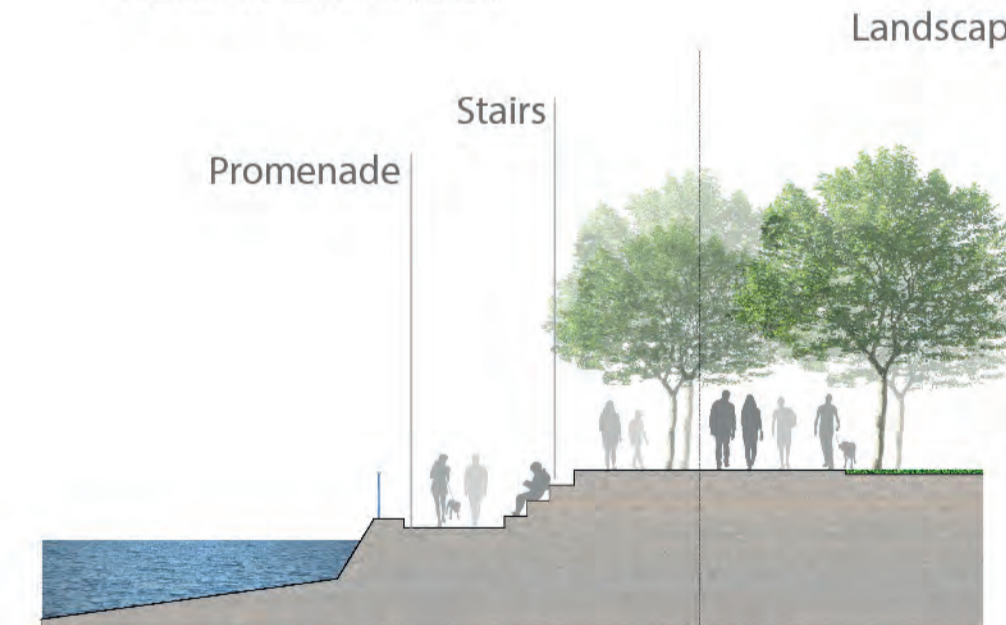

- 6 Public Square
- 7 Rickshaw Station (West)
- 8 Water Park
- 9 Markets
- 10 Wan Chai Ferry Pier
- 11 Harbour Deck
- 12 Waterside Bar
- 13 Waterfront Terrace

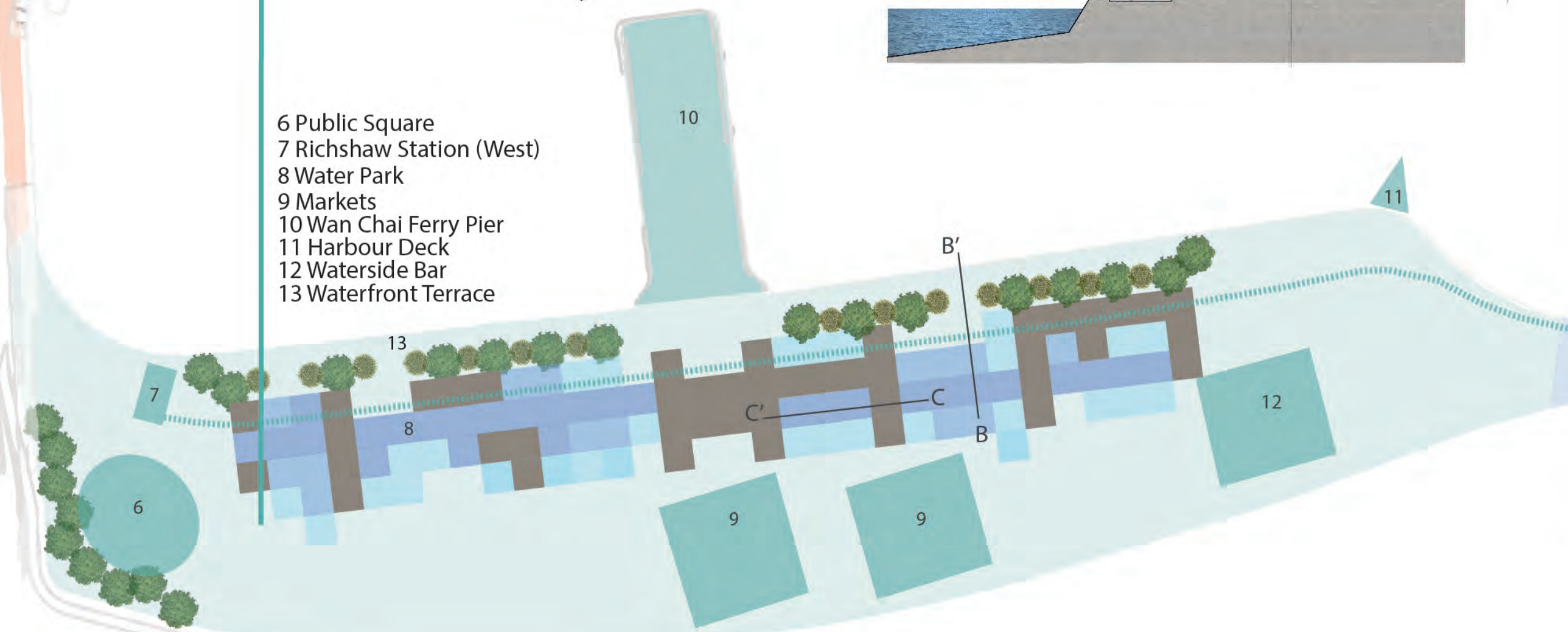

Water Recreation Precinct

It accommodates different types of activities, which aims to foster a closer link between people and water, reinforcing the water-friendly culture in the Wan Chai harbourfront.

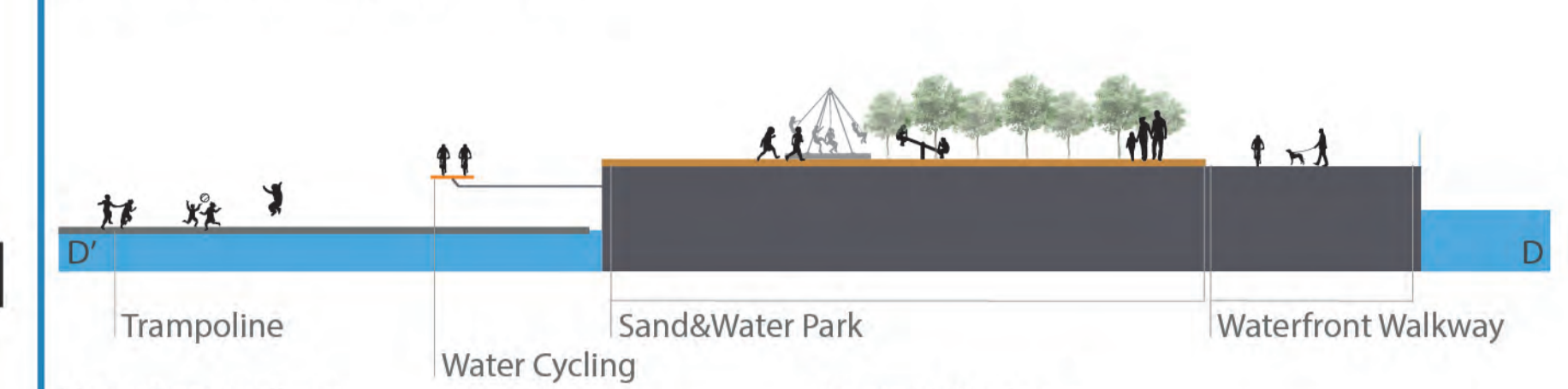

Waterfront Walkway



Precinct Overview



Rickshaw Station (East)



Harbour Deck

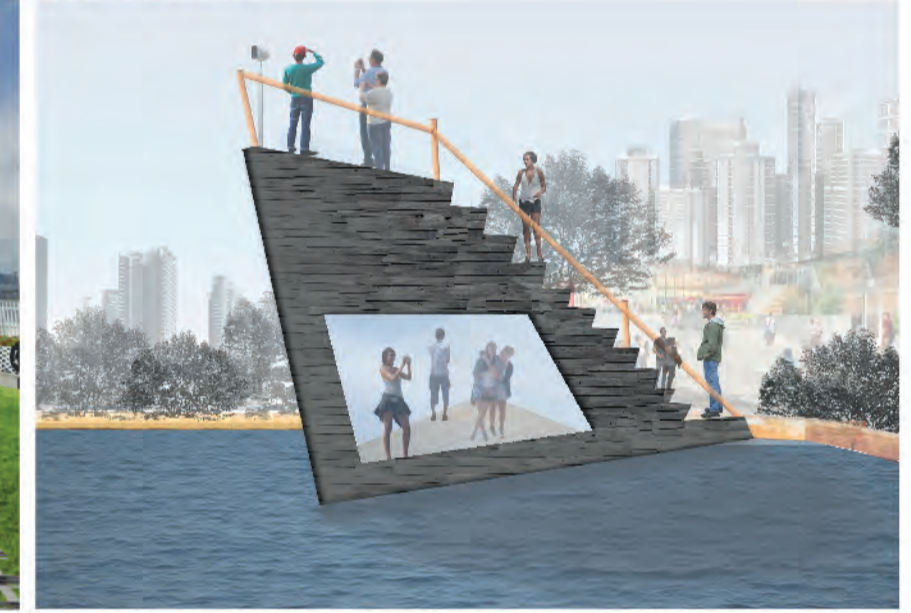

Rickshaw Trail Map

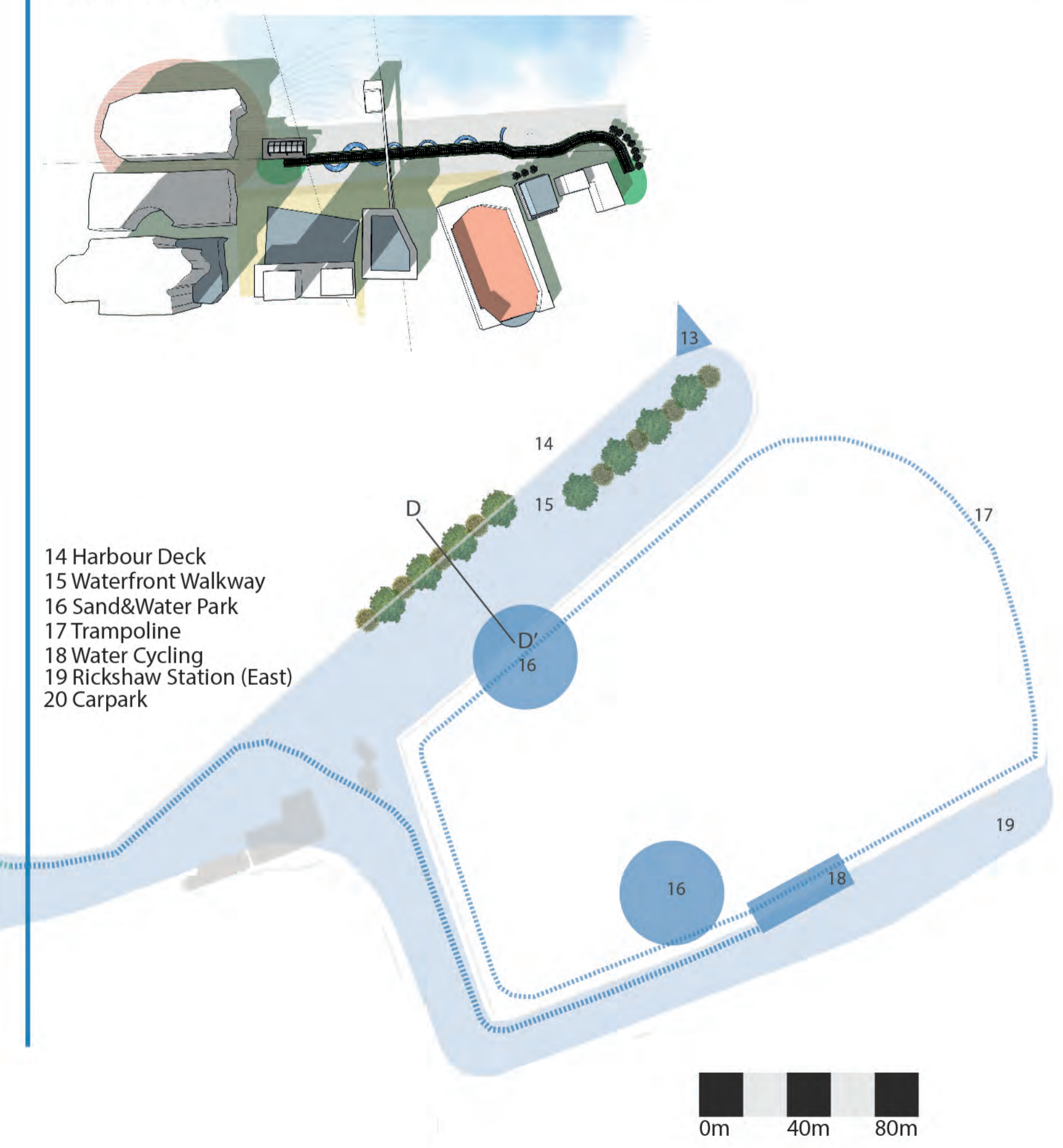

- 14 Harbour Deck
- 15 Waterfront Walkway
- 16 Sand&Water Park
- 17 Trampoline
- 18 Water Cycling
- 19 Rickshaw Station (East)
- 20 Carpark

